

**AX80018 (x3)**  
Hardware parts tree  
Hardware-Teilebaum  
Arbre des pièces de quincaillerie  
Set bulloneria

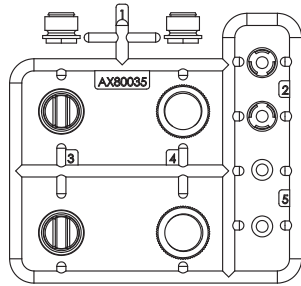

**AX80035 (x2) / AX31301 (Blue) (x2)**  
10mm Shock Caps Parts Tree  
10 mm Stoßdämpfer-Teilebaum  
Arbre des pièces d'amortisseurs 10 mm  
Set ricambi ammortizzatore 10 mm

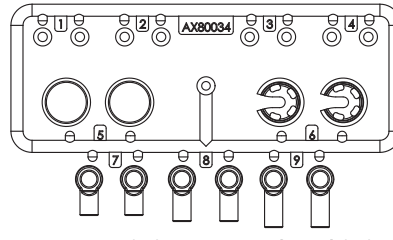

**AX80034 (x2) / AX31300 (Blue) (x2)**  
10mm Shock Parts Tree 2  
10 mm Stoßdämpfer-Teilebaum  
Arbre des pièces d'amortisseurs 10 mm  
Set ricambi ammortizzatore 10 mm

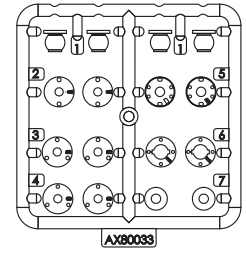

**AX80033 (x2)**  
10mm shock parts tree  
10 mm Stoßdämpfer-Teilebaum  
Arbre des pièces d'amortisseurs 10 mm  
Set ricambi ammortizzatore 10 mm

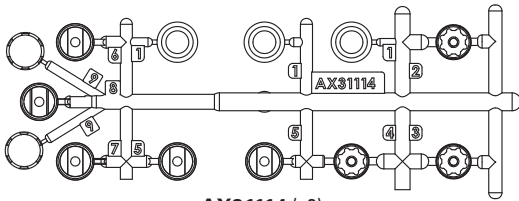

**AX31114 (x2)**  
WB8-HD Standard driveshaft  
WB8-HD Standard-Antriebswelle  
Arbre de transmission standard WB8-HD  
Albero di trasmissione standard WB8-HD

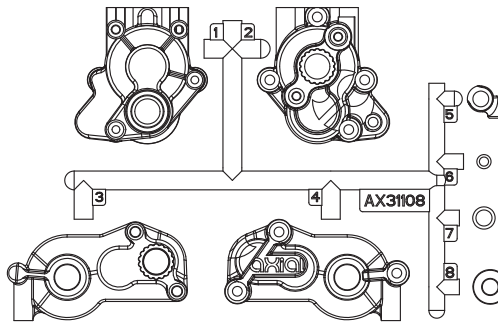

**AX31108 (x1)**  
2-Speed Hi/Lo Transmission Case  
2-Geschwindigkeiten Hi/Lo Getriebeabdeckung  
Boîtier de la transmission élevé/faible 2 vitesses  
Scatola trasmissione 2 velocità alta/bassa (HI/LO)

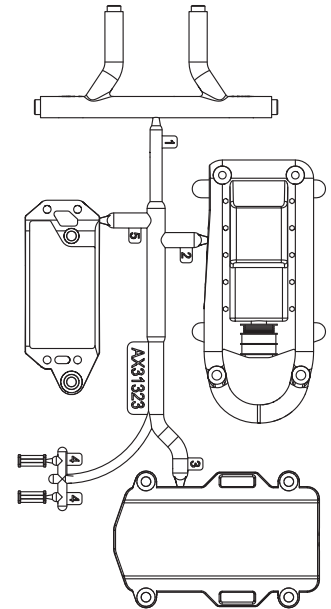

**AX31323 (x1)**  
RR10 Electronics Box  
RR10 Elektronikbox  
Boîtier des composants électroniques RR10  
Scatola elettronica RR10

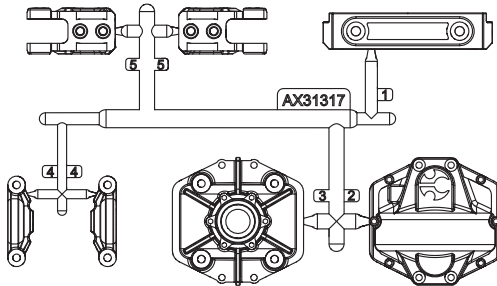

**AX31317 (x2)**  
AR66 Differential Covers  
AR66 Differenzialgehäuse  
Couvercles de différentiel AR66  
Carter differenziale AR66

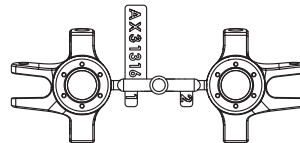

**AX31316 (x1)**  
AR60 Steering knuckles  
AR60 Lenkrollen  
Rotules de direction AR60  
Fusi a snodo AR60

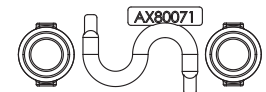

**AX80071 (x1)**  
Straight Axle Adapter Rear  
Gerader Achsadapter hinten  
Adaptateur d'essieu droit arrière  
Adattatore assale dritto posteriore

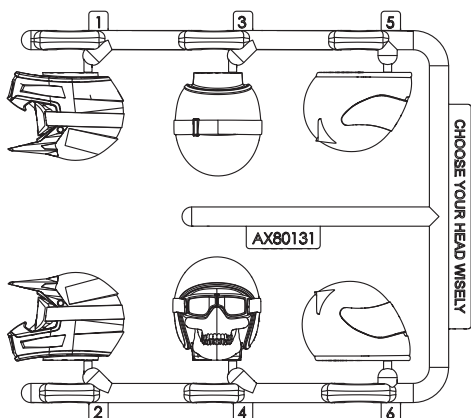

**AX31049 (x2)**  
Helmet Set (Black)  
Helm-Set (schwarz)  
Ensemble de casque (noir)  
Set elmetti (nero)

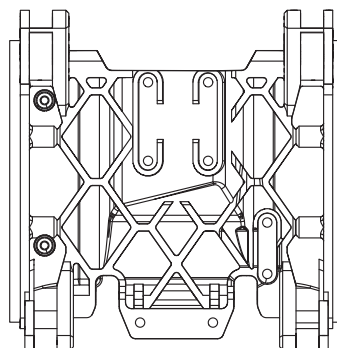

**AX31333 (x1)**  
RR10 Skid Plate  
RR10 Gleitbrett  
Plaque de protection RR10  
Piastra di protezione RR10

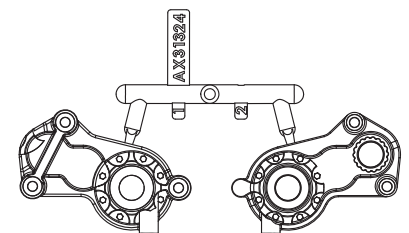

**AX31324 (x1)**  
RR10 Transfer Case  
RR10 Transfergehäuse  
Boîte de transfert RR10  
Custodia di trasferimento RR10

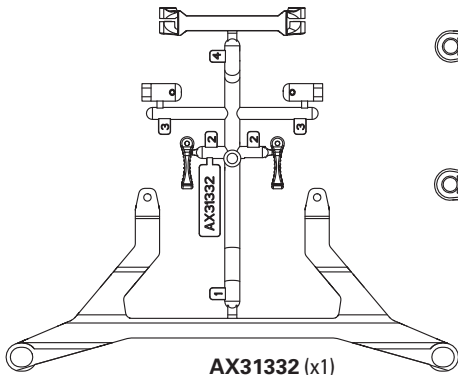

**AX31332 (x1)**  
 RR10 Battery Tray Chassis Components 2  
 RR10 Akkufach Karosseriebauteile 2  
 Composants du châssis du support de batterie RR10 2  
 2 componenti telaio supporto batteria RR10

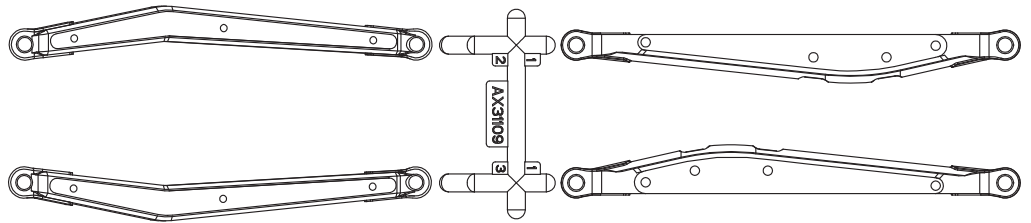

**AX31109 (x1)**  
 Yeti™ Rear 4 Link Set  
 Yeti™ 4-gliedriger Gelenksatz hinten  
 Ensemble de 4 bras arrière Yeti™  
 Set 4 braccetti Yeti™ posteriore

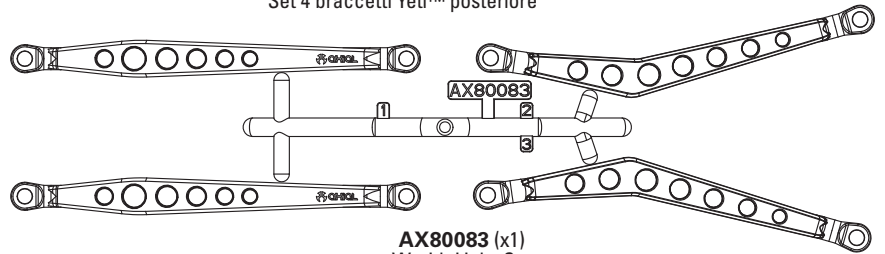

**AX80083 (x1)**  
 Wraith Links Set  
 Wraith-Gestängesatz  
 Ensemble de bras Wraith  
 Set leveraggi Wraith

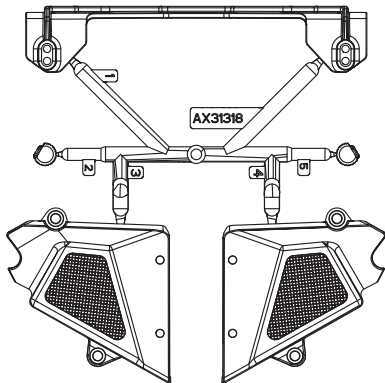

**AX31318 (x1)**  
 RR10 Battery Tray Chassis Components  
 RR10 Akkufach Karosseriebauteile  
 Composants du châssis du support de batterie RR10  
 Componenti telaio supporto batteria RR10

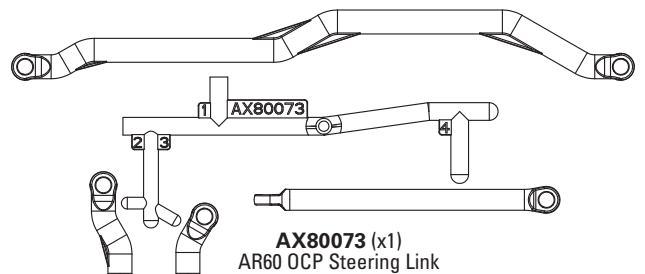

**AX80073 (x1)**  
 AR60 OCP Steering Link  
 AR60 OCP-Lenkstange  
 Tringlerie de direction AR60 OCP  
 Braccetto sterzo AR60 OCP

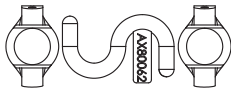

**AX31354 (x1)**  
 AR60 Heavy Duty C-Hub Carrier  
 AR60 robuster C-Nabenträger  
 Support de moyeu en C haute résistance AR60  
 Supporto caster block Heavy Duty AR60



**AX80002 (x2)**  
 Diff Case - Small  
 Differentialgehäuse - Klein  
 Boîtier de différentiel - Petit  
 Scatola diff. - Piccola

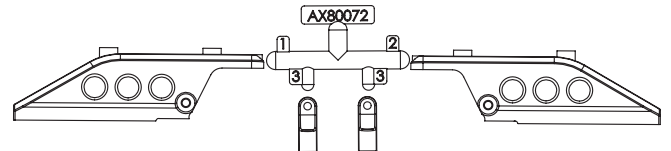

**AX80072 (x1)**  
 Offset Axle 4 Link Mount  
 Achse mit viergliedrigem Gestänge und Versatz  
 Support d'essieu déporté à 4 bras  
 Supporto braccetti 4-link offset assale

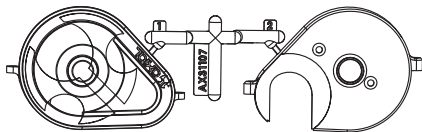

**AX31107 (x1)**  
 2-Speed Hi/Lo Transmission Spur Gear Cover  
 2-Geschwindigkeiten Hi/Lo Getriebe Stirnradabdeckung  
 Cache de l'engrenage cylindrique de la transmission élevé/faible 2 vitesses  
 Carter ingranaggi trasmissione 2 velocità alta/bassa (HI/LO)

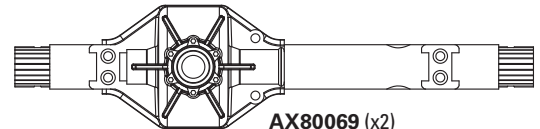

**AX80069 (x2)**  
 Offset Axle Housing  
 Achsgehäuse mit Versatz  
 Carter d'essieu déporté  
 Carcassa assale offset

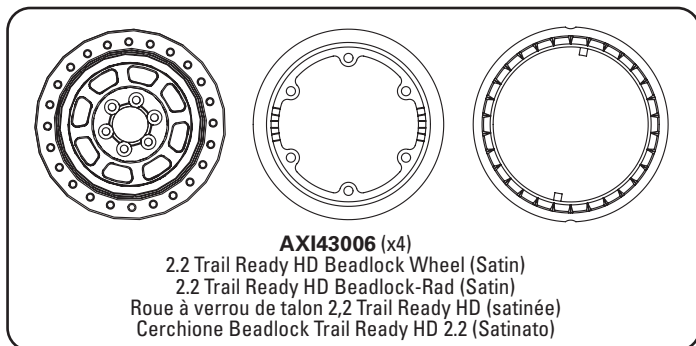

**AXI43006 (x4)**  
 2.2 Trail Ready HD Beadlock Wheel (Satin)  
 2.2 Trail Ready HD Beadlock-Rad (Satin)  
 Roue à verrou de talon 2,2 Trail Ready HD (satinée)  
 Cerchione Beadlock Trail Ready HD 2.2 (Satinato)

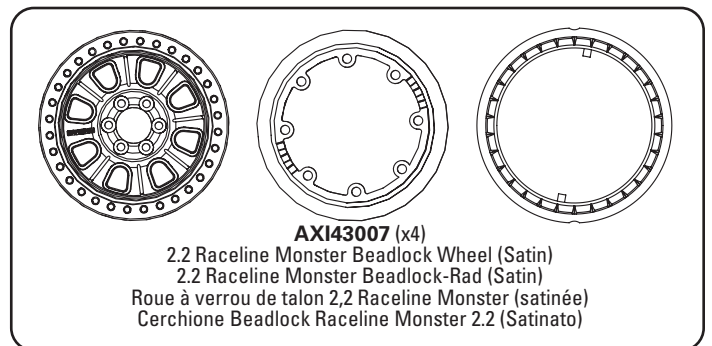

**AXI43007 (x4)**  
 2.2 Raceline Monster Beadlock Wheel (Satin)  
 2.2 Raceline Monster Beadlock-Rad (Satin)  
 Roue à verrou de talon 2,2 Raceline Monster (satinée)  
 Cerchione Beadlock Raceline Monster 2.2 (Satinato)

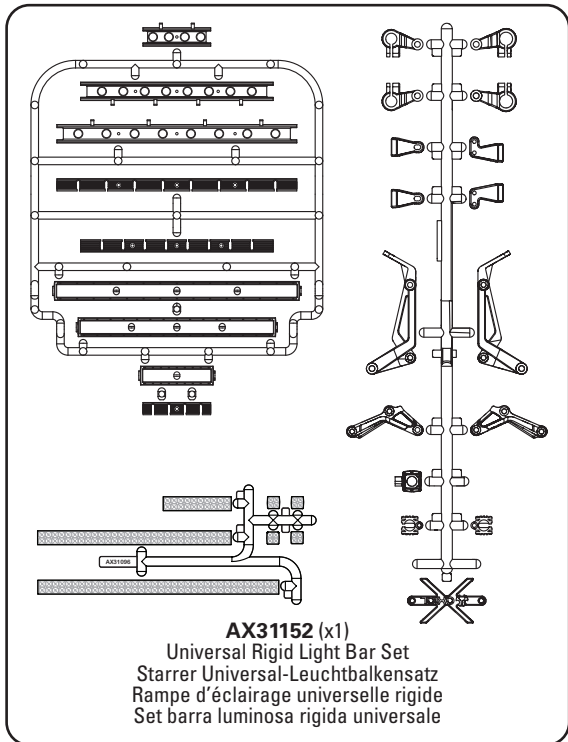

**AX31152 (x1)**  
 Universal Rigid Light Bar Set  
 Starrer Universal-Leuchtbalkensatz  
 Rampe d'éclairage universelle rigide  
 Set barra luminosa rigida universale

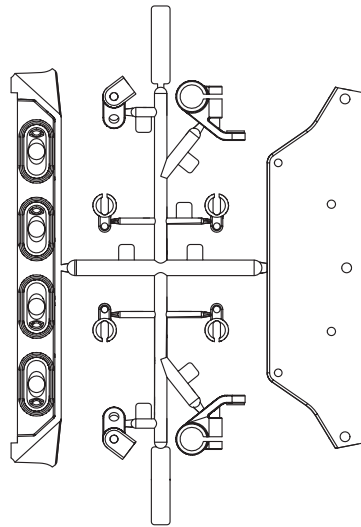

**AXI230014 (x1)**  
 RR10 Rear Light Bar Mount  
 RR10 Hintere Leuchtbalkenhalterung  
 Support de rampe d'éclairage arrière RR10  
 Supporto barra luminosa posteriore RR10

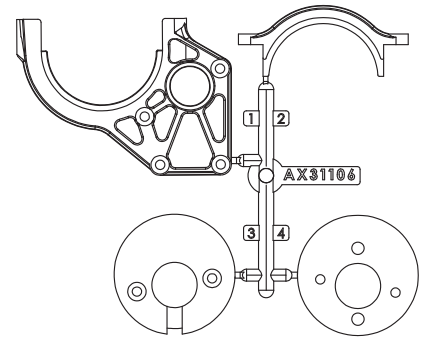

**AX31106 (x1)**  
 2-Speed Hi/Lo Transmission Motor Mount  
 2-Geschwindigkeiten Hi/Lo Getriebe Motorhalterung  
 Support moteur de la transmission élevé/faible 2 vitesses  
 Supporto motore trasmissione 2 velocità alta/bassa (HI/LO)

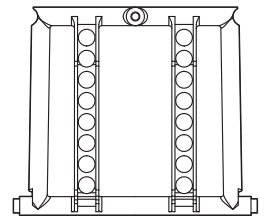

**AX31065 (x1)**  
 Spur Gear 32P 64T  
 Stirnrad 32P 64T  
 Engrenage cylindrique 32P 64T  
 Corona 32P 64T

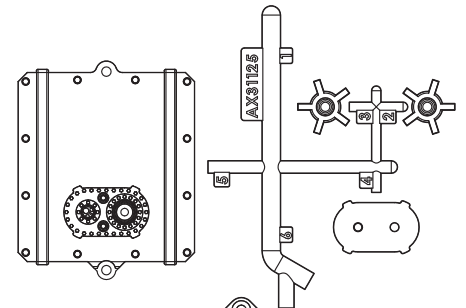
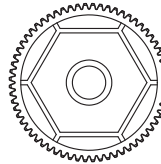

**AX31125 (x1)**  
 Yeti™ Fuel Cell  
 Yeti™ Treibstofftank  
 Réservoir de carburant Yeti™  
 Cella carburante Yeti™

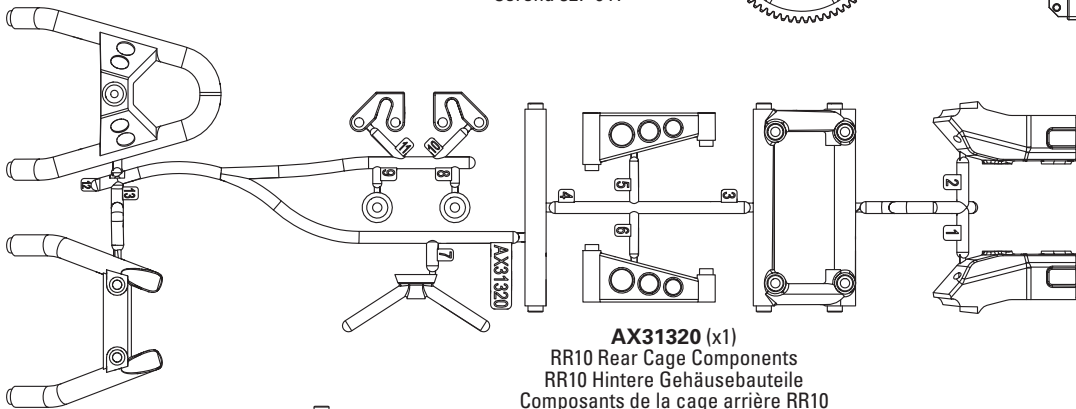

**AX31320 (x1)**  
 RR10 Rear Cage Components  
 RR10 Hintere Gehäusebauteile  
 Composants de la cage arrière RR10  
 Componenti custodia posteriore RR10

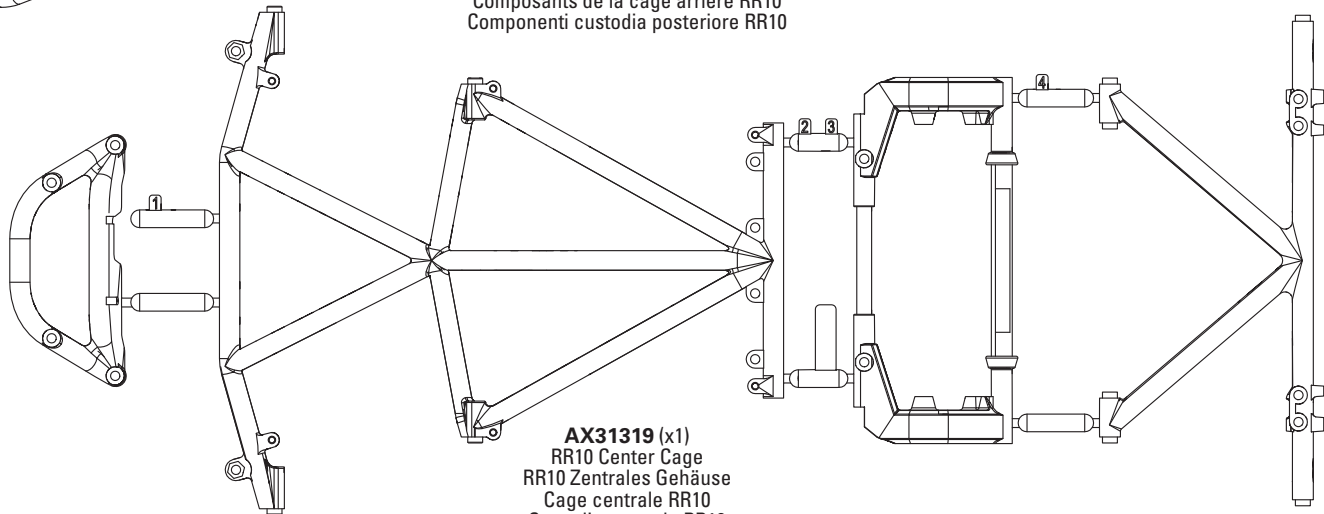

**AX31319 (x1)**  
 RR10 Center Cage  
 RR10 Zentrales Gehäuse  
 Cage centrale RR10  
 Custodia centrale RR10

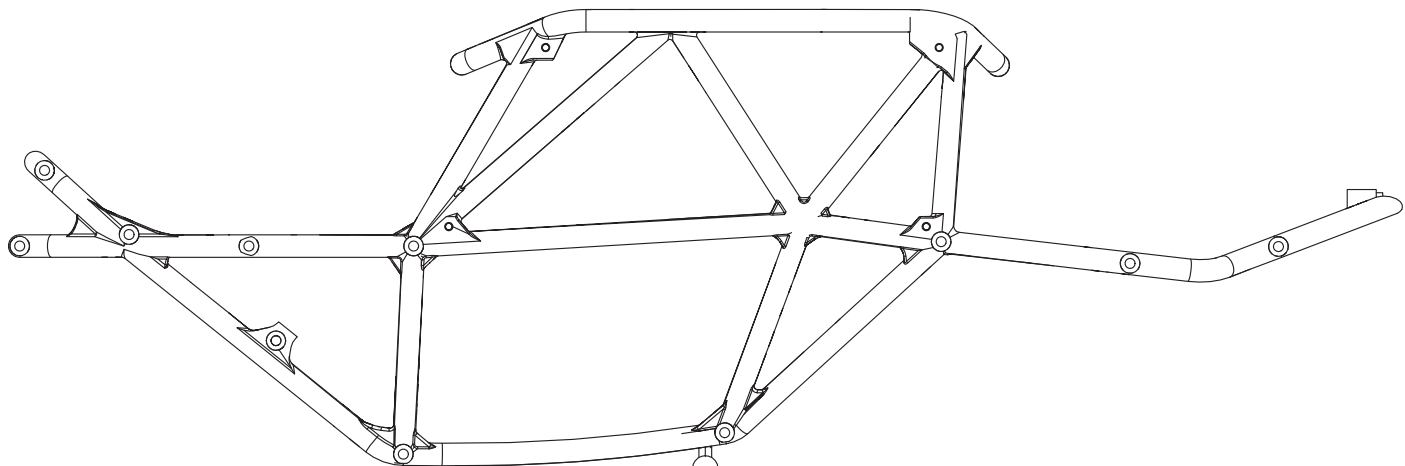

**AX31322(x1)**  
 RR10 Cage Sides (Left and Right)  
 RR10 Gehäuseseiten (Links und Rechts)  
 Côtés de la cage RR10 (gauche et droite)  
 Scocca di protezione laterale (dx e sx) RR10

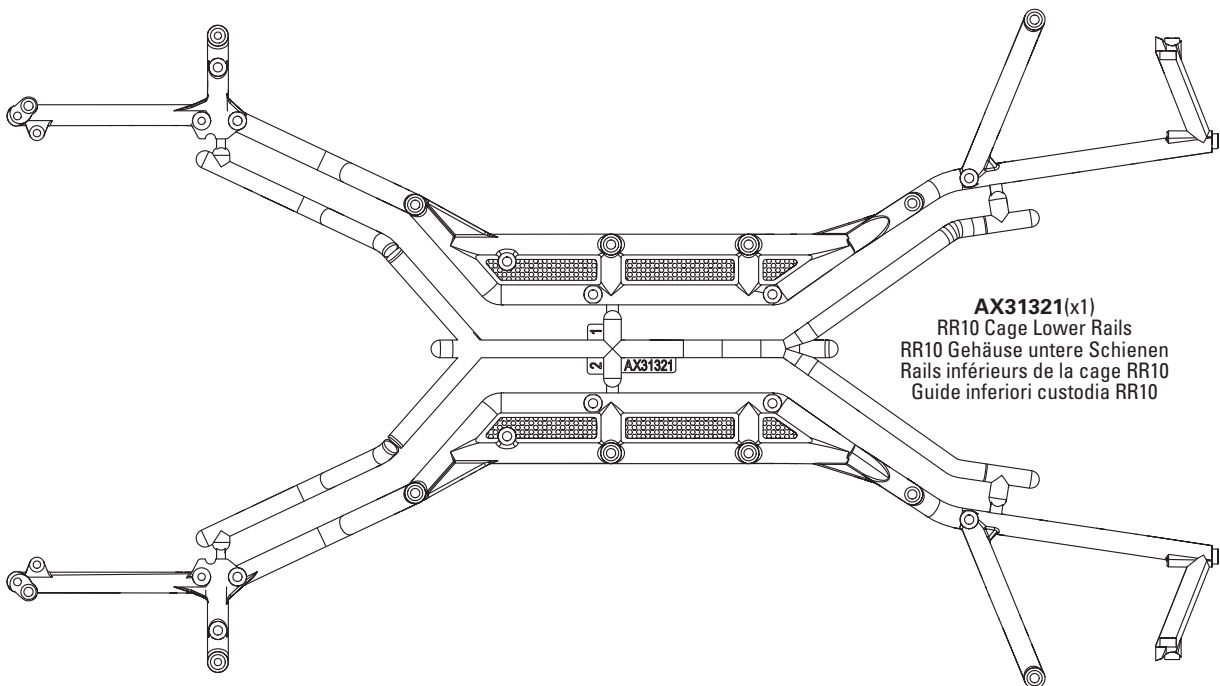
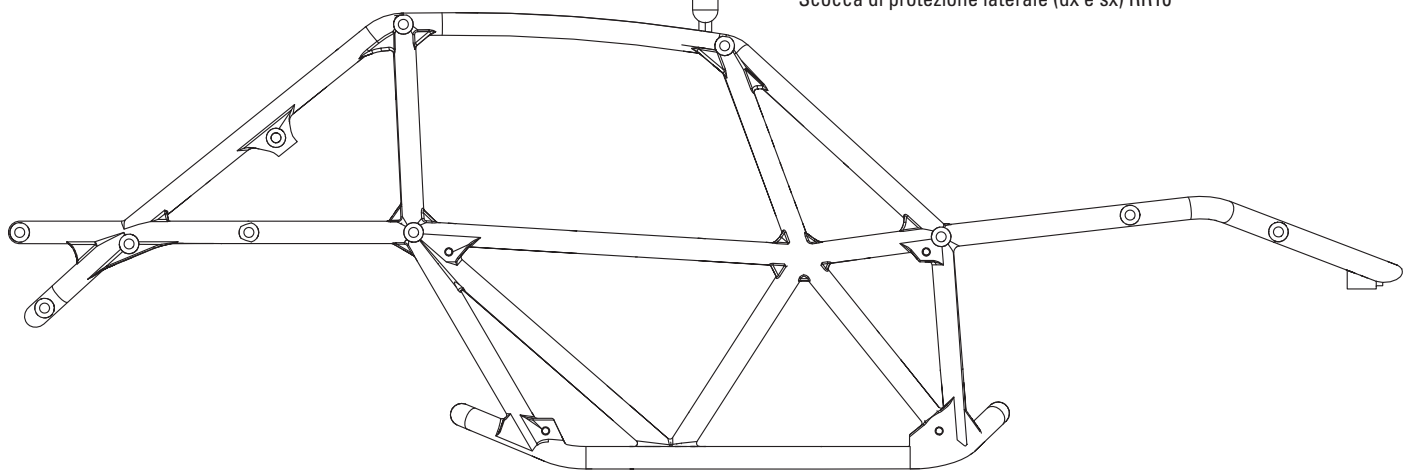

**AX31321(x1)**  
 RR10 Cage Lower Rails  
 RR10 Gehäuse untere Schienen  
 Rails inférieurs de la cage RR10  
 Guide inferiori custodia RR10

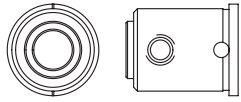
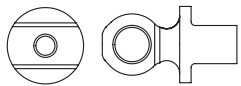

**AX31148 (x4)**  
WB8-HD Driveshaft coupler set  
WB8-HD-Antriebswellenkupplungssatz  
Ensemble de couplage d'arbre de transmission WB8-HD  
Set accoppiamento albero trasmissione WB8-HD

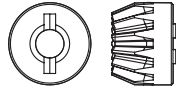
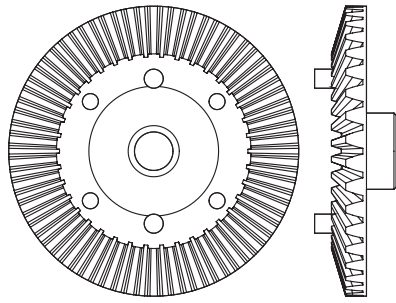

**AX30392 (x2)**  
Bevel Gear Set - 38T/13T  
Kegelradgetriebesatz - 38T/13T  
Ensemble d'engrenages coniques - 38T/13T  
Set ingranaggi conici - 38T/13T



**AX31314 (x4)**  
Aluminum Shock Body 12x47.5mm  
Aluminium Stoßdämpfergehäuse 12 x 47,5 mm  
Aluminium Carrosserie d'amortisseurs en aluminium 12 x 47,5 mm  
Corpo ammortizzatore in alluminio 12x47,5 mm

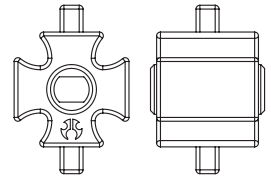

**AX30500 (x2)**  
Heavy Duty Locker  
Robuste Sicherung  
Blocage haute résistance  
Blocco differenziale Heavy Duty

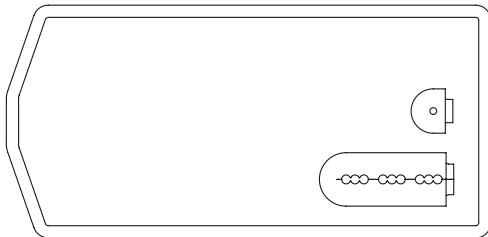

**AX31083 (x1)**  
Radio box seals  
Funkbox-Dichtungen  
Joints du boîtier de radio  
Guarnizioni vano radiocomando

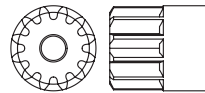

**AX30723 (x1)**  
Pinion 32DP 12T  
Zahnradgetriebe, 32DP, 12T  
Engrenage à pignons, 32DP 12T  
Pignone 32DP, 12T,

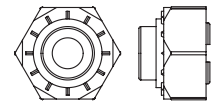

**AX30429 (x4)**  
Narrow 12mm aluminum hub  
Schmale Aluminium-Nabe, 12 mm  
Moyeu étroit en aluminium de 12 mm  
Mozzo stretto in alluminio, 12 mm



**AXI231007 (x1)**  
Metal Servo Horn (23T)  
Metallgetriebehorn (23T)  
Renvoi du servo métallique (23T)  
Servo squadretta in metallo (23 T)



**AX30408 (x2)**  
Steel Input Shaft 5x29mm  
Stahl-Eingangswelle 5 x 29 mm  
Arbre d'entrée en acier 5 x 29 mm  
Albero di entrata in acciaio 5x29 mm

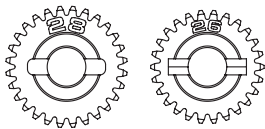

**AX31130 (x1)**  
High Speed Transmission Gear Set (48P 26T, 48P 28T)  
Hochgeschwindigkeits-Getriebesatz (48P 26T, 48P 28T)  
Ensemble d'engrenages de transmission grande vitesse (48P 26T, 48P 28T)  
Set ingranaggi trasmissione alta velocità (48P 26T, 48P 28T)

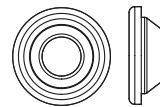

**AX30112 (x4)**  
Shock Diaphragm 13x4.5mm  
Stoßdämpfermembran 13 x 4,5 mm  
Membrane d'amortisseur 13 x 4,5 mm  
Diaframma ammortizzatore 13x4,5 mm



**AX30413 (x1)**  
Slipper spring, 8,5 x 12  
Gleitfeder, 8,5 x 12  
Ressort de sabot, 8,5 x 12  
Molla pattino, 8,5x12

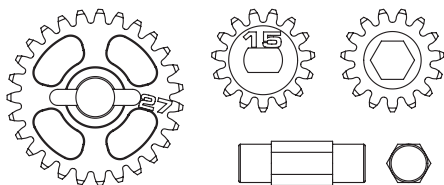

**AX31131 (x1)**  
T-Case Gear Set  
T-Case-Getriebesatz  
Ensemble d'engrenages de boîte de transfert  
Set ingranaggi scatola a T



**AX30113 (x4)**  
Rubber Bump Stop 3.6x7x4mm  
Gummianschlag 3,6 x 7 x 4 mm  
Butée en caoutchouc 3,6 x 7 x 4 mm  
Fine corsa in gomma 3,6x7x4 mm

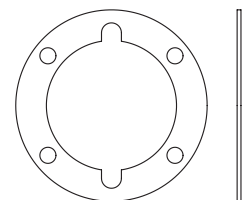

**AX30385 (x2)**  
Diff Gasket 16x25x0.5mm  
Differentialdichtung 16 x 25 x 0,5 mm  
Joint de différentiel 16 x 25 x 0,5 mm  
Guarnizione differenziale 16x25x0,5 mm

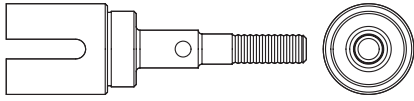

**AX30368** (x2)  
 Axle, 6 x 39mm  
 Achse, 6 x 39 mm  
 Essieu, 6 x 39 mm  
 Assale ,6 x 39 mm

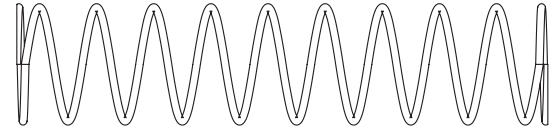

**AX30224** (x2) / **AX31315 (Blue)** (x2)  
 Spring 14x70mm 1.43 lbs/in  
 Feder 14 x 70 mm 1,43 lbs/in  
 Ressort 14 x 70 mm 1,43 lb/po  
 Molla 14x70 mm 1,43 lbs/in

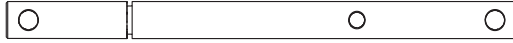

**AX31313** (x1)  
 Transfer Case Output Shaft (5x69mm)  
 Transfergehäuse Antriebswelle (5 x 69 mm)  
 Arbre de sortie de la boîte de transfert (5 x 69 mm)  
 Albero uscita scatola di trasferimento (5x69 mm)

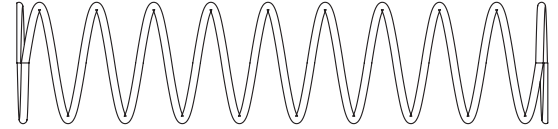

**AX30221** (x2) / **AX31336 (Blue)** (x2)  
 Spring 14x70mm 3.27 lbs/in  
 Feder 14 x 70 mm 3,27 lbs/in  
 Ressort 14 x 70 mm 3,27 lb/po  
 Molla 14x70 mm 3,27 lbs/in

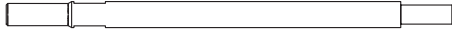

**AX30155** (x4)  
 Shock Shaft 3x59.5mm  
 Kolbenstange, 3 x 59.5 mm  
 Bras d'amortisseur, 3 x 59.5 mm  
 Albero ammortizzatore, 3x59.5 mm

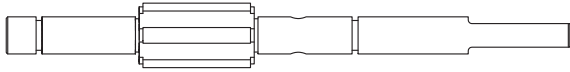

**AX31129** (x1)  
 2-Speed Hi/Lo Transmission Bottom Shaft (5x75mm)  
 2-Geschwindigkeiten Hi/Lo untere Getriebewelle (5 x 75 mm)  
 Arbre inférieur de la transmission élevé/faible 2 vitesses (5 x 75 mm)  
 Albero inferiore trasmissione 2 velocità alta/bassa (HI/LO) (5x75 mm)

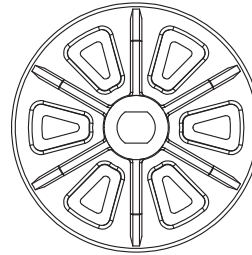

**AX31067** (x1)  
 Slipper Plate  
 Gleitplatte  
 Plaque de sabot  
 Piastra pattino

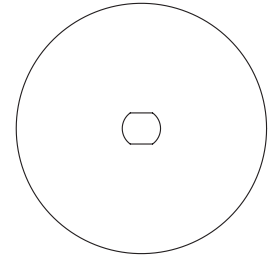

**AX31026** (x2)  
 Slipper plate washer, 33 x 5 x 1.5mm  
 Gleitplattenunterlegscheibe, 33 x 5 x 1,5 mm  
 Rondelle de plaque de sabot, 33 x 5 x 1,5 mm  
 Rondella piastra pattino, 33x5x1,5 mm

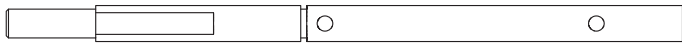

**AX31127** (x1)  
 2-Speed Hi/Lo Transmission Top Shaft (5x91mm)  
 2-Geschwindigkeiten Hi/Lo obere Getriebewelle (5 x 91 mm)  
 Arbre supérieur de la transmission élevé/faible 2 vitesses (5 x 91 mm)  
 Albero superiore trasmissione 2 velocità alta/bassa (HI/LO) (5x91 mm)

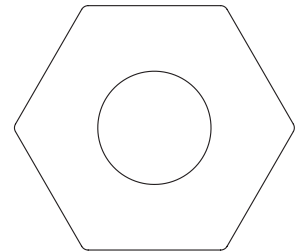

**AX31068** (x2)  
 Slipper pad, 32.8 x 15.2 x 1mm  
 Gleitkissen 32,8 x 15,2 x 1 mm  
 Sabot de piston, 32,8 x 15,2 x 1 mm  
 Piastra guida, 32,8x15,2x1 mm

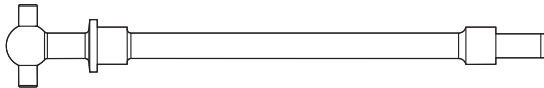

**AX30419** (x1)  
 AR60 OCP Front Dogbone 7x69mm  
 AR60 OCP Vorderes Dogbone 7 x 69 mm  
 Dogbone avant AR60 OCP 7 x 69 mm  
 Cardano anteriore AR60 OCP 7x69 mm

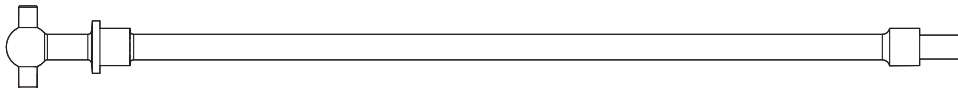

**AX30419** (x1)  
 AR60 OCP Front Dogbone 7x125mm  
 AR60 OCP Vorderes Dogbone 7 x 125 mm  
 Dogbone avant AR60 OCP 7 x 125 mm  
 Cardano anteriore AR60 OCP 7x125 mm

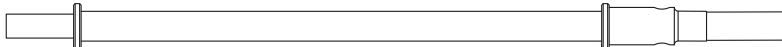

**AX30776** (x1)  
 AR60 OCP Rear Axle 6x104.2mm  
 AR60 OCP Hinterachse 6 x 104,2 mm  
 Essieu arrière AR60 OCP 6 x 104,2 mm  
 Assale posteriore AR60 OCP 6x104,2 mm



**AX30776** (x1)  
 AR60 OCP Rear Axle 6x160.2mm  
 AR60 OCP Hinterachse 6 x 160,2 mm  
 Essieu arrière AR60 OCP 6 x 160,2 mm  
 Assale posteriore AR60 OCP 6x160,2 mm

**AX30163** (x5)  
Pin 2x10mm  
Stift 2 x 10 mm  
Goupille 2 x 10 mm  
Perno 2 x 10 mm

**AX31028** (x8)  
Pin 2x11mm  
Stift 2 x 11 mm  
Goupille 2 x 11 mm  
Perno 2 x 11 mm

**AXA1393** (x2)  
E2.5 e-clip  
E2.5 E-Clip  
E-clip E2.5  
E-clip E2.5

**AXA1391** (x2)  
E4 e-clip  
E4 E-Clip  
E-clip E4  
E-clip E4

**AXA1045** (x1)  
M4 Nylon Lock Nut  
M4 Nylon-Feststellmutter  
Contre-écrou en nylon M4  
Controdado nylon M4

**AX31250** (x4)  
M4 Serrated Nylon Lock Nut  
Feststellflanschmutter (schwarz)  
Contre-écrou en nylon strié (noir) M4  
Controdado dentato nylon (nero) M4

**AXA1041** (x4)  
M2.5 Nylon Lock Nut  
M2.5 Nylon-Feststellmutter  
Contre-écrou en nylon M2.5  
Controdado nylon M2.5

**AXA1052** (x6)  
M3 Thin Nylon Locking Hex Nut  
M3 dünne Nylon-Feststellmutter  
Contre-écrou à six pans fin en nylon M3  
Controdado esagonale nylon sottile M3

**AXA1053** (x3)  
M3 Nylon Lock Nut  
M3 Nylon-Feststellmutter  
Contre-écrou en nylon M3  
Controdado nylon M3

**AXA1070** (x1)  
Washer 3 x 6 x 0,5mm  
Unterlegscheibe 3 x 6 x 0,5mm  
Rondelle 3 x 6 x 0,5mm  
Rondella 3x 6 x 0,5mm

**AXA1069** (x8)  
Washer 2.7x6.7x0.5mm  
Unterlegscheibe 2.7x 6.7 x 0,5mm  
Rondelle 2.7x6.7x0,5mm  
Rondella 2.7x 6.7 x 0,5mm

**AXA1071** (x2)  
Washer 4x8x0.5mm  
Unterlegscheibe 4x 8 x 0,5mm  
Rondelle 4x8x0,5mm  
Rondella 4x 8 x 0,5mm

**AXA1202** (x8)  
O-Ring 3.5 x 2mm  
O-Ring 3,5 x 2mm  
Joint torique 3,5 x 2mm  
O-Ring 3.5 x 2mm

**AXA1184** (x4)  
O-Ring 7.5 x 1.5mm  
O-Ring 7,5 x 1.5mm  
Joint torique 7,5 x 1.5mm  
O-Ring 7.5 x 1.5mm

**AXA1221** (x20)  
Bearing 5x11x4mm  
Lager 5 x 11 x 4 mm  
Roulement 5 x 11 x 4 mm  
Cuscinetto 5x11x4 mm

**AXA1230** (x6)  
Bearing 10x15x4mm  
Lager 10 x 15 x 4 mm  
Roulement 10 x 15 x 4 mm  
Cuscinetto 10x15x4 mm

**AXA180** (x12)  
M3x3mm Set Screw  
M3 x 3 mm Schraubensatz  
Vis de fixation M3 x 3 mm  
Vite di arresto M3x3 mm

**AXA291** (x1)  
M4x4mm Set Screw  
M4 x 4 mm Schraubensatz  
Vis de fixation M4 x 4 mm  
Vite di arresto M4x4 mm

**AXA186** (x8)  
M3x16mm Set Screw  
M3 x 16 mm Schraubensatz  
Vis de fixation M3 x 16 mm  
Vite di arresto M3x16 mm

**AXA0187** (x4)  
M3x20mm Set Screw  
M3 x 20 mm Schraubensatz  
Vis de fixation M3 x 20 mm  
Vite di arresto M3x20 mm

**AXA0286** (x4)  
Screw Shaft M4x2.5x12mm  
Gewindenschaft M4 x 2,5 x 12 mm  
Tige de vis M4 x 2,5 x 12 mm  
Albero filettato M4 x 2,5 x 12 mm

**AXA013** (x5)  
M2x6mm Hex Socket Cap Head  
M2 x 6 mm Sechskant-Inbusschraube  
Douille à six pans d'assemblage creuse M2 x 6 mm  
Vite testa cilindrica con esagono incassato M2x6 mm

**AXA015** (x16)  
M2x10mm Hex Socket Cap Head  
M2 x 10 mm Sechskant-Inbusschraube  
Douille à six pans d'assemblage creuse M2 x 10 mm  
Vite testa cilindrica con esagono incassato M2x10 mm

**AXA0023** (x28)  
M2.6x8mm Cap Head  
M2.6 x 8 mm Sechskant-Inbusschraube  
Douille à six pans d'assemblage creuse M2.6 x 8 mm  
Vite testa cilindrica con esagono incassato M2.6x8 mm

**AXA087** (x8)  
M3x16mm Hex Socket Cap Head  
M3 x 16 mm Sechskant-Inbusschraube  
Douille à six pans d'assemblage creuse M3 x 16 mm  
Vite testa cilindrica con esagono incassato M3x16 mm

**AXA091** (x2)  
M3x30mm Hex Socket Cap Head  
M3 x 30 mm Sechskant-Inbusschraube  
Douille à six pans d'assemblage creuse M3 x 30 mm  
Vite testa cilindrica con esagono incassato M3x30 mm

**AX31121** (x2)  
M4x12mm Cap Head  
M4 x 12 mm Sechskant-Inbusschraube  
Douille à six pans d'assemblage creuse M4 x 12 mm  
Vite testa cilindrica con esagono incassato M4x12 mm



**AX31280** (x16)  
M2.6x6mm Hex Socket Button Head  
M2.6x6mm Sechskant-Rundkopf  
Douille à six pans à tête bombée M2.6x6mm  
Vite testa tonda con esagono incassato M2.6x6mm



**AXA0113** (x11)  
M3x6mm Hex Socket Button Head  
M3 x 6 mm Sechskant-Rundkopf  
Douille à six pans à tête bombée M3 x 6 mm  
Vite testa tonda con esagono incassato M3x6 mm



**AXA114** (x6)  
M3x8mm Hex Socket Button Head  
M3 x 8 mm Sechskant-Rundkopf  
Douille à six pans à tête bombée M3 x 8 mm  
Vite testa tonda con esagono incassato M3x8 mm



**AXA115** (x22)  
M3x10mm Hex Socket Button Head  
M3 x 10 mm Sechskant-Rundkopf  
Douille à six pans à tête bombée M3 x 10 mm  
Vite testa tonda con esagono incassato M3x10 mm



**AXA116** (x49)  
M3x12mm Hex Socket Button Head  
M3 x 12 mm Sechskant-Rundkopf  
Douille à six pans à tête bombée M3 x 12 mm  
Vite testa tonda con esagono incassato M3x12 mm



**AXA117** (x17)  
M3x15mm Hex Socket Button Head  
M3 x 15 mm Sechskant-Rundkopf  
Douille à six pans à tête bombée M3 x 15 mm  
Vite testa tonda con esagono incassato M3x15 mm



**AXA118** (x46)  
M3x18mm Hex Socket Button Head  
M3 x 18 mm Sechskant-Rundkopf  
Douille à six pans à tête bombée M3 x 18 mm  
Vite testa tonda con esagono incassato M3x18 mm



**AXA119** (x1)  
M3x20mm Hex Socket Button Head  
M3 x 20 mm Sechskant-Rundkopf  
Douille à six pans à tête bombée M3 x 20 mm  
Vite testa tonda con esagono incassato M3x20 mm



**AXA121** (x4)  
M3x30mm Hex Socket Button Head  
M3 x 30 mm Sechskant-Rundkopf  
Douille à six pans à tête bombée M3 x 30 mm  
Vite testa tonda con esagono incassato M3x30 mm



**AXA144** (x10)  
M3x8mm Hex Socket Flat Head  
M3 x 8 mm Sechskant-Flachkopf  
Douille à six pans à tête plate M3 x 8 mm  
Vite testa piana con esagono incassato M3x8 mm



**AX31185** (x2)  
M3x10mm Hex Socket Flat Head  
M3 x 10 mm Sechskant-Flachkopf  
Douille à six pans à tête plate M3 x 10 mm  
Vite testa piana con esagono incassato M3x10 mm



**AXA146** (x17)  
M3x12mm Hex Socket Flat Head  
M3 x 12 mm Sechskant-Flachkopf  
Douille à six pans à tête plate M3 x 12 mm  
Vite testa piana con esagono incassato M3x12 mm



**AXA0147** (x1)  
M3x16mm Hex Socket Flat Head  
M3 x 16 mm Sechskant-Flachkopf  
Douille à six pans à tête plate M3 x 16 mm  
Vite testa piana con esagono incassato M3x16 mm



**AXA148** (x8)  
M3x18mm Hex Socket Flat Head  
M3 x 18 mm Sechskant-Flachkopf  
Douille à six pans à tête plate M3 x 18 mm  
Vite testa piana con esagono incassato M3x18 mm



**AXA150** (x3)  
M3x25mm Hex Socket Flat Head  
M3 x 25 mm Sechskant-Flachkopf  
Douille à six pans à tête plate M3 x 25 mm  
Vite testa piana con esagono incassato M3x25 mm



**AXA0413** (x2)  
M2.6x8mm Hex Socket Tapping Flat Head  
M2.6 x 8 mm Sechskant-Flachkopf-Blechschaube  
Douille à six pans à tête plate autotaraudeuse M2.6 x 8 mm  
Vite autofilettante testa piana con esagono incassato M2.6x8 mm



**AXA436** (x1)  
M3x12mm Button Head Tapping  
M3 x 12 mm Rundkopf-Blechschaube  
Vis autotaraudeuse à tête bombée M3 x 12 mm  
Vite autofilettante testa tonda M3x12 mm



**AXA0439** (x2)  
M3x20mm Button Head Tapping  
M3 x 20 mm Rundkopf-Blechschaube  
Vis autotaraudeuse à tête bombée M3 x 20 mm  
Vite autofilettante testa tonda M3x20 mm



**AXA441** (x4)  
M3x30mm Hex Socket Tapping Button Head  
M3 x 30 mm Rundkopf-Blechschaube  
Vis autotaraudeuse à tête bombée M3 x 30 mm  
Vite autofilettante testa tonda M3x30 mm



**AXA0109** (x4)  
M3x10mm Oversized Flat Hex Socket  
M3 x 10 mm übergroßer Sechskant-Flachkopf  
Douille à six pans à tête plate surdimensionnée M3 x 10 mm  
Vite testa piana con esagono incassato sovramisura M3x10 mm



**AX30450** (x4)  
Flange Pipe 3x4.5x5.5  
Flanschrohr 3 x 4,5 x 5,5  
Tubulure bridée 3 x 4,5 x 5,5  
Tubo flangiato 3x4,5x5,5

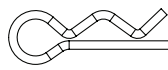

**AXA1059** (x2)  
6mm Body Clip  
6 mm Gehäuseklemme  
Clip de carrosserie 6 mm  
Clip 6 mm





**FRONT AXLE  
VORDERACHSE  
ESSIEU AVANT  
ASSALE ANTERIORE**

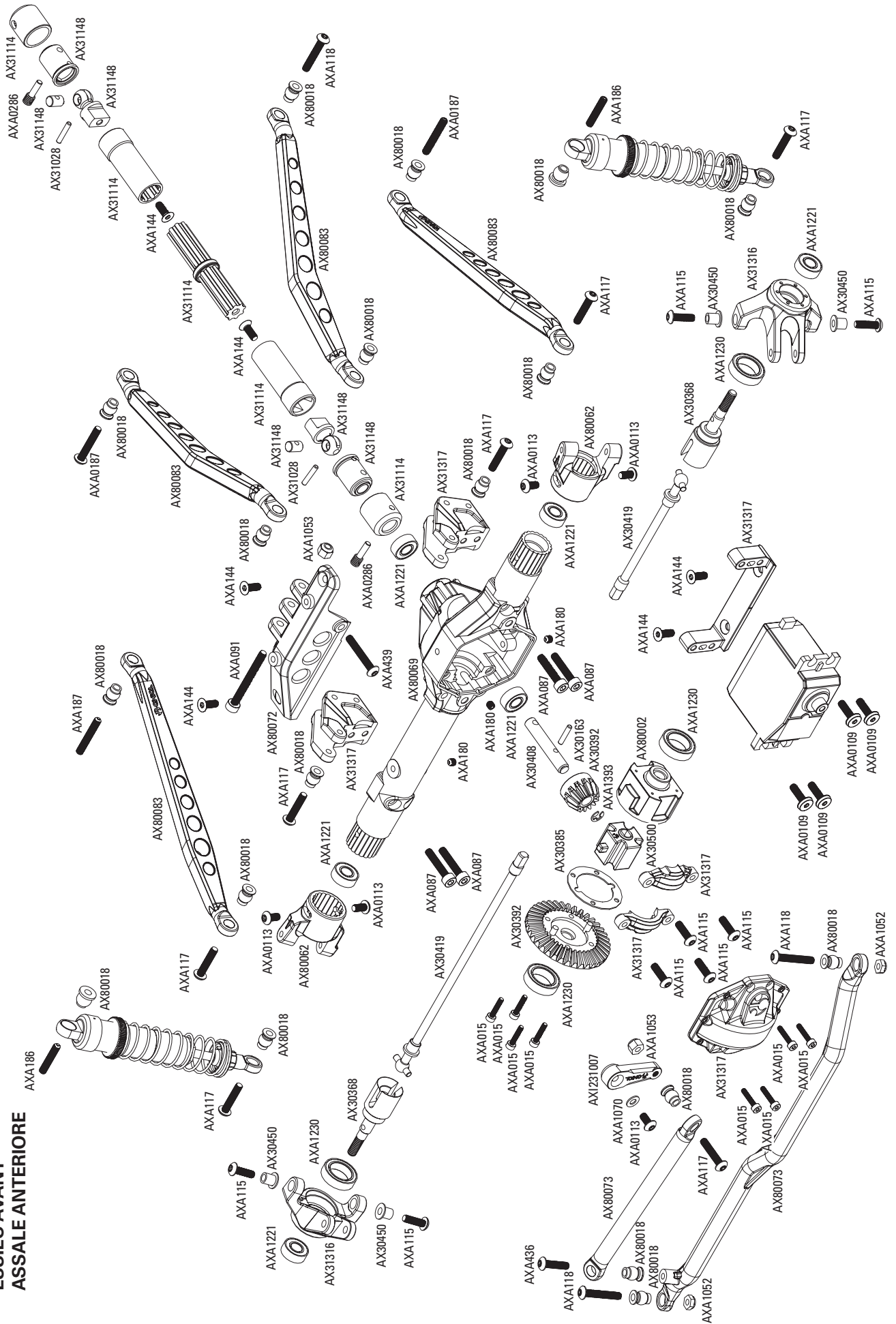



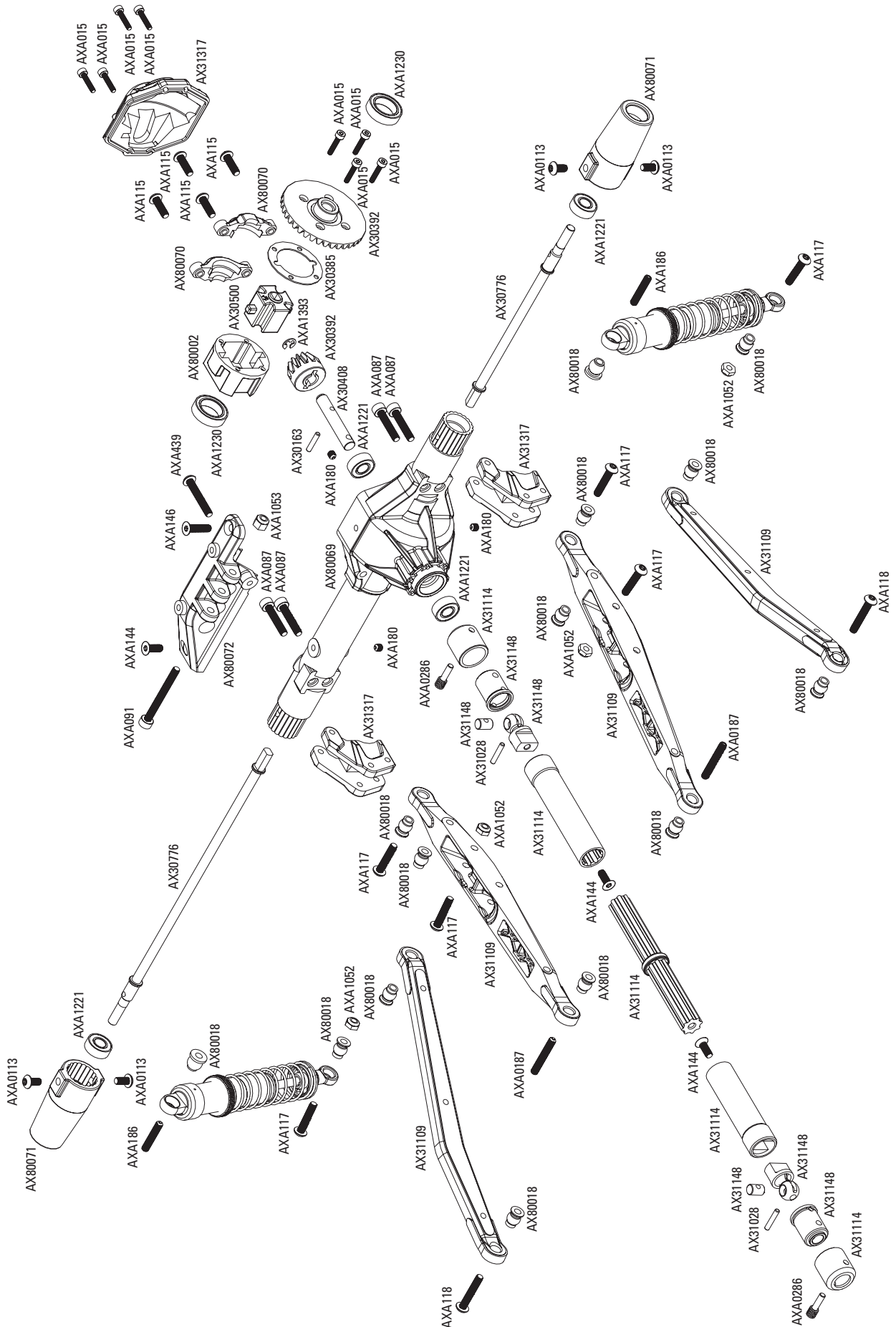





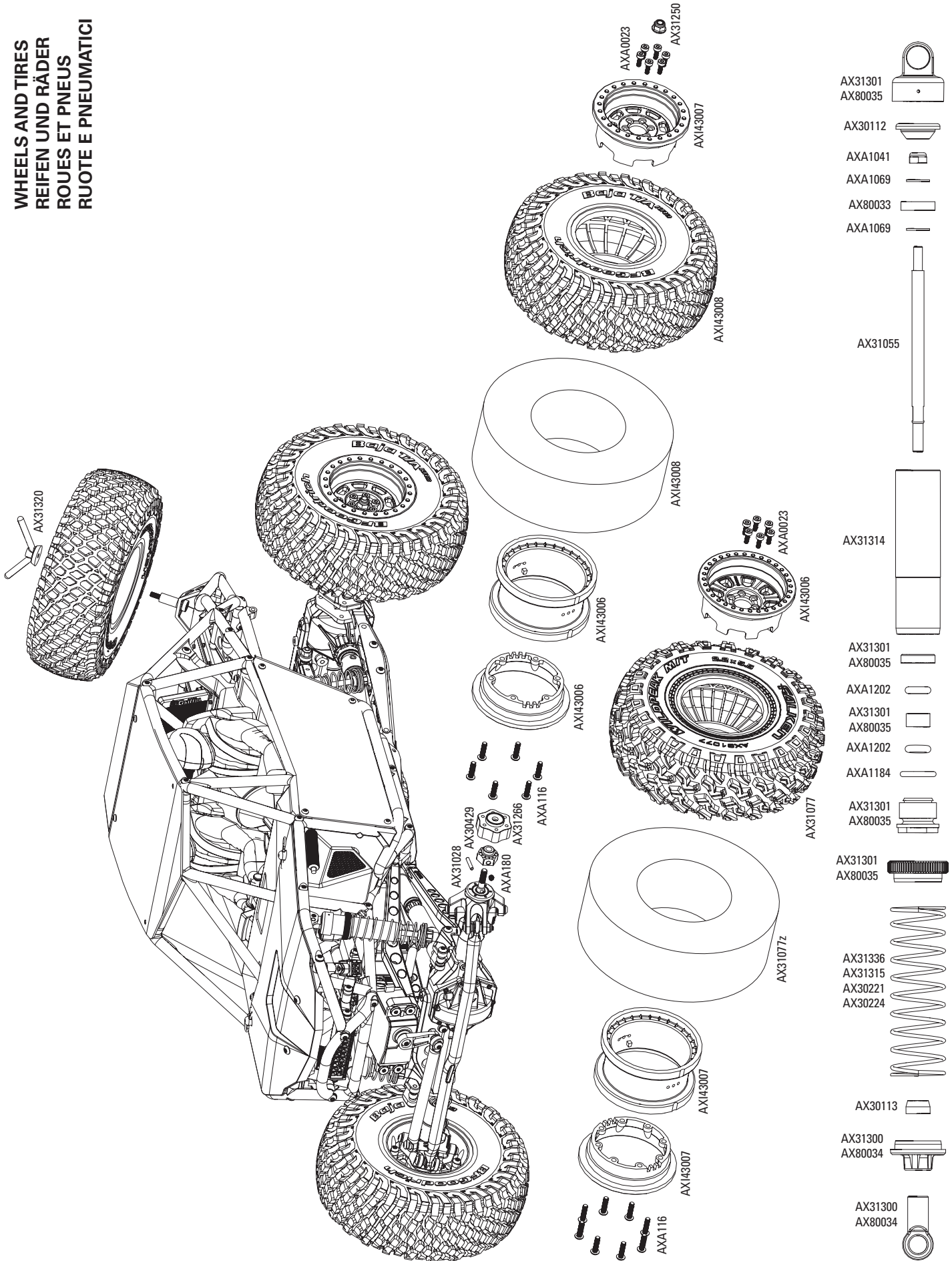





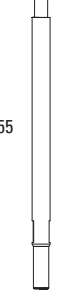
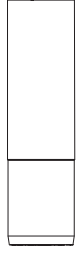

**REAR AXLE  
HINTERACHSE  
ESSEU ARRIÈRE  
ASSALE POSTERIORE**

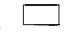

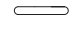

WHEELS AND TIRES  
 REIFEN UND RÄDER  
 ROUES ET PNEUS  
 RUOTE E PNEUMATICI

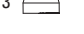
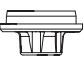

- AX31301  
AX80035 
- AX30112 
- AXA1041 
- AXA1069 
- AX80033 
- AXA1069 
- AX31055 
- AX31314 
- AX31301  
AX80035 
- AXA1202 
- AX31301  
AX80035 
- AXA1202 
- AXA1184 
- AX31301  
AX80035 
- AX31301  
AX80035 
- AX31336  
AX31315  
AX30221  
AX30224 
- AX30113 
- AX31300  
AX80034 
- AX31300  
AX80034 

**PARTS LISTS // TEILELISTEN // LISTE DES PIÈCES // ELENCO COMPONENTI**

Part #	Description	Beschreibung	Description	Descrizione
AX30113	Rubber Bump Stop 3.6x7x4 (6pcs)	Gummianschlag 3,6 x 7 x 4 mm	Butée en caoutchouc 3,6 x 7 x 4 mm	Fine corsa in gomma 3,6x7x4 mm
AX30155	Shock Shaft 3x59.5 (2pcs)	Kolbenstange, 3 x 59.5 mm	Bras d'amortisseur, 3 x 59.5 mm	Albero ammortizzatore, 3x59.5 mm
AX30163	Pin 2.0x10mm (6pcs.)	Stift 2 x 10 mm	Goupille 2 x 10 mm	Perno 2 x 10 mm
AX30368	Axle 6x39mm (2pcs)	Achse, 6 x 39 mm	Essieu, 6 x 39 mm	Assale ,6 x 39 mm
AX30385	Diff Gasket 16x25x0.5mm (2pcs)	Differentialdichtung 16 x 25 x 0,5 mm	Joint de différentiel 16 x 25 x 0,5 mm	Guarnizione differenziale 16x25x0,5 mm
AX30392	Bevel Gear Set - 38T/13T	Kegelradgetriebesatz - 38T/13T	Ensemble d'engrenages coniques - 38T/13T	Set ingranaggi conici - 38T/13T
AX30408	Steel Input Shaft 5x29mm (2pcs)	Stahl-Eingangswelle 5 x 29 mm	Arbre d'entrée en acier 5 x 29 mm	Albero di entrata in acciaio 5x29 mm
AX30413	Slipper spring 8.5x12 165 lbs/in - Black (2pcs)	Gleitfeder, 8,5 x 12	Ressort de sabot, 8,5 x 12	Molla pattino, 8,5x12
AX30419	AR60 OCP Front Dogbone	AR60 OCP Vorderes Dogbone	Dogbone avant AR60 OCP	Cardano anteriore AR60 OCP
AX30429	12mm Aluminum Hub (Black) (4pcs)	Schmale Aluminium-Nabe, 12 mm	Moyeu étroit en aluminium de 12 mm	Mozzo stretto in alluminio, 12 mm
AX30450	Flange Pipe 3x4.5x5.5 (4pcs)	Flanschrohr 3 x 4,5 x 5,5	Tubulure bridée 3 x 4,5 x 5,5	Tubo flangiato 3x4,5x5,5
AX30500	Heavy Duty Locker (2pcs)	Robuste Sicherung	Blocage haute résistance	Blocco differenziale Heavy Duty
AX30723	Pinion Gear 32P 12T - Steel (3mm Motor Shaft)	Zahnradgetriebe, 32DP, 12T	Engrenage à pignons,, 32DP 12T	Pignone 32DP, 12T,
AX30776	AR60 OCP Rear Axle Set (2pcs)	AR60 OCP Hinterachse	Essieu arrière AR60 OCP	Assale posteriore AR60 OCP
AX31028	Pin 2x11mm (6pcs)	Stift 2 x 11 mm	Goupille 2 x 11 mm	Perno 2 x 11 mm
AX31049	Helmet Set (Black)	Helm-Set (schwarz)	Ensemble de casque (noir)	Set elmetti (nero)
AX31059	Slipper Plate Washer 33x1mm (2pcs)			
AX31065	Spur Gear 32P 64T	Stirnrad 32P 64T	Engrenage cylindrique 32P 64T	Corona 32P 64T
AX31067	Slipper Plate (2pcs)	Gleitplatte	Plaque de sabot	Piastra pattino
AX31068	Slipper Pad 32.8x15.2x1mm (2pcs)	Gleitkissen 32,8 x 15,2 x 1 mm	Sabot de piston, 32,8 x 15,2 x 1 mm	Piastra guida, 32,8x15,2x1 mm
AX31083	Radio Box Seals	Funkbox-Dichtungen	Joints du boîtier de radio	Guarnizioni vano radiocomando
AX31106	2-Speed Hi/Lo Transmission Motor Mount	2-Geschwindigkeiten Hi/Lo Getriebe Motorhalterung	Support moteur de la transmission élevé/faible 2 vitesses	Supporto motore trasmissione 2 velocità alta/bassa (HI/LO)
AX31107	2-Speed Hi/Lo Transmission Spur Gear Cover	2-Geschwindigkeiten Hi/Lo Getriebe Stirnradabdeckung	Cache de l'engrenage cylindrique de la transmission élevé/faible 2 vitesses	Carter ingranaggi trasmissione 2 velocità alta/bassa (HI/LO)
AX31108	2-Speed Hi/Lo Transmission Case	2-Geschwindigkeiten Hi/Lo Getriebeabdeckung	Boîtier de la transmission élevé/faible 2 vitesses	Scatola trasmissione 2 velocità alta/bassa (HI/LO)
AX31109	Yeti™ Rear 4 Link Set	Yeti™ 4-gliedriger Gelenksatz hinten	Ensemble de 4 bras arrière Yeti™	Set 4 braccetti Yeti™ posteriore
AX31114	WB8-HD Standard driveshaft	WB8-HD Standard-Antriebswelle	Arbre de transmission standard WB8-HD	Albero di trasmissione standard WB8-HD
AX31121	M4x12mm Cap Head (Black) (10pcs)	M4 x 12 mm Sechskant-Inbusschraube	Douille à six pans d'assemblage creuse M4 x12 mm	Vite testa cilindrica con esagono incassato M4x12 mm
AX31125	Yeti™ Fuel Cell	Yeti™ Treibstofftank	Réservoir de carburant Yeti™	Cella carburante Yeti™
AX31127	2-Speed Hi/Lo Transmission Top Shaft (5x91mm)	2-Geschwindigkeiten Hi/Lo obere Getriebewelle (5 x 91 mm)	Arbre supérieur de la transmission élevé/faible 2 vitesses (5 x 91 mm)	Albero superiore trasmissione 2 velocità alta/bassa (HI/LO) (5x91 mm)
AX31129	2-Speed Hi/Lo Transmission Bottom Shaft (5x75mm)	2-Geschwindigkeiten Hi/Lo untere Getriebewelle (5 x 75 mm)	Arbre inférieur de la transmission élevé/faible 2 vitesses (5 x 75 mm)	Albero inferiore trasmissione 2 velocità alta/bassa (HI/LO) (5x75 mm)
AX31130	High Speed Transmission Gear Set (48P 26T, 48P 28T)	Hochgeschwindigkeits-Getriebesatz (48P 26T, 48P 28T)	Ensemble d'engrenages de transmission grande vitesse (48P 26T, 48P 28T)	Set ingranaggi trasmissione alta velocità (48P 26T, 48P 28T)
AX31148	WB8-HD Driveshaft Coupler Set	WB8-HD-Antriebswellenkupplungssatz	Ensemble de couplage d'arbre de transmission WB8-HD	Set accoppiamento albero trasmissione WB8-HD
AX31185	M3x10mm Hex Socket Flat Head (Black) (10pcs)	M3 x 10 mm Sechskant-Flachkopf	Douille à six pans à tête plate M3 x 10 mm	Vite testa piana con esagono incassato M3x10 mm
AX31250	M4 Serrated Nylon Lock Nut (Black) (10pcs)	Feststellflanschmutter (schwarz)	Contre-écrou en nylon strié (noir) M4	Controdado dentato nylon (nero) M4
AX31300	10mm Shock Parts Tree 2 (Blue)	10 mm Stoßdämpfer-Teilebaum	Arbre des pièces d'amortisseurs 10 mm	Set ricambi ammortizzatore 10 mm
AX31301	10mm Shock Caps Parts Tree (Blue)	10 mm Stoßdämpfer-Teilebaum	Arbre des pièces d'amortisseurs 10 mm	Set ricambi ammortizzatore 10 mm
AX31312	35T Electric Motor	35T Elektromotor	Moteur électrique 35T	Motore elettrico 35T
AX31313	Transfer Case Output Shaft (5x69mm)	Transfergehäuse Antriebswelle (5 x 69 mm)	Arbre de sortie de la boîte de transfert (5 x 69 mm)	Albero uscita scatola di trasferimento (5x69 mm)
AX31314	Aluminum Shock Body 12x47.5mm	Aluminium Stoßdämpfergehäuse 12 x 47,5 mm	Carrosserie d'amortisseurs en aluminium 12 x 47,5 mm	Corpo ammortizzatore in alluminio 12x47,5 mm
AX31315	Spring 14x70mm 1.43 lbs/in - Purple (2pcs) (Blue Springs)	Feder 14 x 70 mm 1,43 lbs/in	Ressort 14 x 70 mm 1,43 lb/po	Molla 14x70 mm 1,43 lbs/in
AX31316	AR60 Double Shear Steering Knuckle Set	AR60 Lenkrollen	Rotules de direction AR60	Fusi a snodo AR60

Part #	Description	Beschreibung	Description	Descrizione
AX31317	AR66 Differential Covers	AR66 Differenzialgehäuse	Couvercles de différentiel AR66	Carter differenziale AR66
AX31318	RR10 Battery Tray Chassis Components	RR10 Akkufach Karosseriebauteile	Composants du châssis du support de batterie RR10	Componenti telaio supporto batteria RR10
AX31319	RR10 Center Cage	RR10 Zentrales Gehäuse	Cage centrale RR10	Custodia centrale RR10
AX31320	RR10 Rear Cage Components	RR10 Hintere Gehäusebauteile	Composants de la cage arrière RR10	Componenti custodia posteriore RR10
AX31321	RR10 Cage Lower Rails	RR10 Gehäuse untere Schienen	Rails inférieurs de la cage RR10	Guide inferiori custodia RR10
AX31322	RR10 Cage Sides (Left and Right)	RR10 Gehäuseseiten (Links und Rechts)	Côtés de la cage RR10 (gauche et droite)	Scocca di protezione laterale (dx e sx) RR10
AX31323	RR10 Electronics Box	RR10 Elektronikbox	Boîtier des composants électroniques RR10	Scatola elettronica RR10
AX31324	RR10 Transfer Case	RR10 Transfergehäuse	Boîte de transfert RR10	Custodia di trasferimento RR10
AX31327	RR10 Bomber Body - .040" (Clear)	Carrosserie du Bomber 0,040 clair RR10	Bomber-Karosserie 0,040 Transparent RR10	Scocca Bomber .040 trasparente RR10
AX31328	Interior Set .040 Clear RR10	Ensemble d'intérieur 0,040 clair RR10	Innenausstattungsatz 0,040 Transparent RR10	Set interno .040 trasparente RR10
AX31332	RR10 Battery Tray Chassis Components 2	RR10 Akkufach Karosseriebauteile 2	Composants du châssis du support de batterie RR10 2	2 componenti telaio supporto batteria RR10
AX31333	RR10 Skid Plate	RR10 Gleitbrett	Plaque de protection RR10	Piastra di protezione RR10
AX31336	Spring 14x70mm 3.27 lbs/in - Yellow (2pcs) (Blue Springs)	Feder 14 x 70 mm 3,27 lbs/in	Ressort 14 x 70 mm 3,27 lb/po	Molla 14x70 mm 3,27 lbs/in
AX80002	Diff Case -Small	Differentialgehäuse – Klein	Boîtier de différentiel - Petit	Scatola diff. - Piccola
AX80018	Hardware Parts Tree	Hardware-Teilebaum	Arbre des pièces de quincaillerie	Set bulloneria
AX80033	10mm Shock Parts Tree	10 mm Stoßdämpfer-Teilebaum	Arbre des pièces d'amortisseurs 10 mm	Set ricambi ammortizzatore 10 mm
AX80069	Offset Axle Housing	Achsgehäuse mit Versatz	Carter d'essieu déporté	Carcassa assale offset
AX80071	Straight Axle Adapter Rear	Gerader Achsadapter hinten	Adaptateur d'essieu droit arrière	Adattatore assale dritto posteriore
AX80072	AR60 OCP 4-Link Mount	Achse mit viergliedrigem Gestänge und Versatz	Support d'essieu déporté à 4 bras	Supporto braccetti 4-link offset assale
AX80073	AR60 OCP Steering Link	AR60 OCP-Lenkstange	Tringlerie de direction AR60 OCP	Braccetto sterzo AR60 OCP
AX80083	Wraith Links Set	Wraith-Gestängesatz	Ensemble de bras Wraith	Set leveraggi Wraith
AXA0023	M2.6x8mm Cap Head (Black) (10pcs)	M2.6 x 8 mm Sechskant-Inbusschraube	Douille à six pans d'assemblage creuse M2.6 x 8 mm	Vite testa cilindrica con esagono incassato M2.6x8 mm
AXA0109	M3x10mm Oversized Flat Hex Socket (Black) (10pcs)	M3 x 10 mm übergroßer Sechskant-Flachkopf	Douille à six pans à tête plate surdimensionnée M3 x 10 mm	Vite testa piana con esagono incassato sovrasmisura M3x10 mm
AXA0113	M3x6mm Hex Socket Button Head (Black) (10pcs)	M3 x 6 mm Sechskant-Rundkopf	Douille à six pans à tête bombée M3 x 6 mm	Vite testa tonda con esagono incassato M3x6 mm
AXA0147	M3x16mm Hex Socket Flat Head (Black) (10pcs)	M3 x 16 mm Sechskant-Flachkopf	Douille à six pans à tête plate M3 x 16 mm	Vite testa piana con esagono incassato M3x16 mm
AXA015	M2x10mm Cap Head (Black) (10pcs)	M2 x 10 mm Sechskant-Inbusschraube	Douille à six pans d'assemblage creuse M2 x 10 mm	Vite testa cilindrica con esagono incassato M2x10 mm
AXA0187	M3x20mm Set Screw (Black) (10pcs)	M3 x 20 mm Schraubensatz	Vis de fixation M3 x 20 mm	Vite di arresto M3x20 mm
AXA0286	Screw Shaft M4x2.5x12mm (6pcs)	Gewindenschaft M4 x 2,5 x 12 mm	Tige de vis M4 x 2,5 x 12 mm	Albero filettato M4 x 2,5 x 12 mm
AXA0413	M2.6x8mm Hex Socket Tapping Flat Head (Black) (10pcs)	M2.6 x 8 mm Sechskant-Flachkopf-Blechschrabe	Douille à six pans à tête plate autotaraudeuse M2.6 x 8 mm	Vite autofilettante testa piana con esagono incassato M2.6x8 mm
AXA0439	M3x20mm Hex Socket Tapping Button Head (Black) (10pcs)	M3 x 20 mm Rundkopf-Blechschrabe	Vis autotaraudeuse à tête bombée M3 x 20 mm	Vite autofilettante testa tonda M3x20 mm
AXA087	M3x16mm Hex Socket Cap Head (Black) (10pcs)	M3 x 16 mm Sechskant-Inbusschraube	Douille à six pans d'assemblage creuse M3 x 16 mm	Vite testa cilindrica con esagono incassato M3x16 mm
AXA091	M3x30mm Hex Socket Cap Head - (Black) (10pcs)	M3 x 30 mm Sechskant-Inbusschraube	Douille à six pans d'assemblage creuse M3 x 30 mm	Vite testa cilindrica con esagono incassato M3x30 mm
AXA1041	M2.5 Nylon Locking Hex Nut - Silver (10pcs)	M2.5 Nylon-Feststellmutter	Contre-écrou en nylon M2.5	Controdado nylon M2.5
AXA1045	M4 Nylon Lock Nut (Black) (10pcs)	M4 Nylon-Feststellmutter	Contre-écrou en nylon M4	Controdado nylon M4
AXA1052	M3 Thin Nylon Locking Hex Nut (Black)	M3 dünne Nylon-Feststellmutter	Contre-écrou à six pans fin en nylon M3	Controdado esagonale nylon sottile M3
AXA1053	M3 Nylon Locking Hex Nut (Black) (10pcs)	M3 Nylon-Feststellmutter	Contre-écrou en nylon M3	Controdado nylon M3
AXA1059	6mm Body clip (Black) (10pcs)	6 mm Gehäuseklemme	Clip de carrosserie 6 mm	Clip 6 mm
AXA1069	Washer 2.7x6.7x0.5 (10pcs)	Unterlegscheibe 2.7x 6.7 x 0,5mm	Rondelle 2.7x6.7x0,5mm	Rondella 2.7x 6.7 x 0,5mm
AXA1070	Washer 3x6x0.5 (10pcs)	Unterlegscheibe 3 x 6 x 0,5mm	Rondelle 3 x 6 x 0,5mm	Rondella 3x 6 x 0,5mm
AXA1071	Washer 4x8x0.5mm (10pcs)	Unterlegscheibe 4x 8 x 0,5mm	Rondelle 4x8x0,5mm	Rondella 4x 8 x 0,5mm
AXA114	M3x8mm Hex Socket Button Head (Black) (10pcs)	M3 x 8 mm Sechskant-Rundkopf	Douille à six pans à tête bombée M3 x 8 mm	Vite testa tonda con esagono incassato M3x8 mm
AXA115	M3x10mm Hex Socket Button Head (Black) (10pcs)	M3 x 10 mm Sechskant-Rundkopf	Douille à six pans à tête bombée M3 x 10 mm	Vite testa tonda con esagono incassato M3x10 mm

Part #	Description	Beschreibung	Description	Descrizione
AXA116	M3x12mm Hex Socket Button Head - Black (10pcs)	M3 x 12 mm Sechskant-Rundkopf	Douille à six pans à tête bombée M3 x 12 mm	Vite testa tonda con esagono incassato M3x12 mm
AXA117	M3x15mm Hex Socket Button Head (Black) (10pcs)	M3 x 15 mm Sechskant-Rundkopf	Douille à six pans à tête bombée M3 x 15 mm	Vite testa tonda con esagono incassato M3x15 mm
AXA118	M3x18mm Hex Socket Button Head - Black (10pcs)	M3 x 18 mm Sechskant-Rundkopf	Douille à six pans à tête bombée M3 x 18 mm	Vite testa tonda con esagono incassato M3x18 mm
AXA1184	O-Ring 7.5x1.5mm (S8) - (10pcs)	O-Ring 7,5 x 1.5mm	Joint torique 7,5 x 1.5mm	O-Ring 7.5 x 1.5mm
AXA119	M3x20mm Hex Socket Button Head (Black) (10pcs)	M3 x 20 mm Sechskant-Rundkopf	Douille à six pans à tête bombée M3 x 20 mm	Vite testa tonda con esagono incassato M3x20 mm
AXA1202	O-Ring 3.5x2mm (10pcs)	O-Ring 3,5 x 2mm	Joint torique 3,5 x 2mm	O-Ring 3.5 x 2mm
AXA121	M3x30mm Hex Socket Button Head (Black) (10pcs)	M3 x 30 mm Sechskant-Rundkopf	Douille à six pans à tête bombée M3 x 30 mm	Vite testa tonda con esagono incassato M3x30 mm
AXA1221	Bearing 5x11x4mm (2pcs)	Lager 5 x 11 x 4 mm	Roulement 5 x 11 x 4 mm	Cuscinetto 5x11x4 mm
AXA1230	Bearing 10x15x4mm	Lager 10 x 15 x 4 mm	Roulement 10 x 15 x 4 mm	Cuscinetto 10x15x4 mm
AXA1391	E4 e-clip (10pcs)	E4 E-Clip	E-clip E4	E-clip E4
AXA1393	E2.5 e-clip (10pcs)	E2.5 E-Clip	E-clip E2.5	E-clip E2.5
AXA144	M3x8mm Hex Socket Flat Head (Black) (10pcs)	M3 x 8 mm Sechskant-Flachkopf	Douille à six pans à tête plate M3 x 8 mm	Vite testa piana con esagono incassato M3x8 mm
AXA146	M3x12mm Hex Socket Flat Head - Black (10pcs)	M3 x 12 mm Sechskant-Flachkopf	Douille à six pans à tête plate M3 x 12 mm	Vite testa piana con esagono incassato M3x12 mm
AXA148	M3x18mm Hex Socket Flat Head (Black) (10pcs)	M3 x 18 mm Sechskant-Flachkopf	Douille à six pans à tête plate M3 x 18 mm	Vite testa piana con esagono incassato M3x18 mm
AXA150	M3x25mm Hex Socket Flat Head (Black) (10pcs)	M3 x 25 mm Sechskant-Flachkopf	Douille à six pans à tête plate M3 x 25 mm	Vite testa piana con esagono incassato M3x25 mm
AXA180	M3x3mm Set Screw (Black) (10pcs)	M3 x 3 mm Schraubensatz	Vis de fixation M3 x 3 mm	Vite di arresto M3x3 mm
AXA186	M3x16mm Set Screw (Black) (10pcs)	M3 x 16 mm Schraubensatz	Vis de fixation M3 x 16 mm	Vite di arresto M3x16 mm
AXA291	M4x4mm Set Screw (Black) (6pcs.)	M4 x 4 mm Schraubensatz	Vis de fixation M4 x 4 mm	Vite di arresto M4x4 mm
AXA436	M3x12mm Hex Socket Tapping Button Head (Black) (10pcs)	M3 x 12 mm Rundkopf-Blechschaube	Vis autotaraudeuse à tête bombée M3 x 12 mm	Vite autofilettante testa tonda M3x12 mm
AXA441	M3x30mm Hex Socket Tapping Button Head (Black) (10pcs)	M3 x 30 mm Rundkopf-Blechschaube	Vis autotaraudeuse à tête bombée M3 x 30 mm	Vite autofilettante testa tonda M3x30 mm
AXI43006	2.2 Trail Ready HD Beadlock Wheel (Satin)	2.2 Trail Ready HD Beadlock-Rad (Satin)	Roue à verrou de talon 2,2 Trail Ready HD (satinée)	Cerchione Beadlock Trail Ready HD 2.2 (Satinato)
AXI43007	2.2 Raceline Monster Beadlock Wheel (Satin)	2.2 Raceline Monster Beadlock-Rad (Satin)	Roue à verrou de talon 2,2 Raceline Monster (satinée)	Cerchione Beadlock Raceline Monster 2.2 (Satinato)
AXIC3221	Spring 14x70mm 3.27lbs in Firm Yellow (2)	Feder 14 x 70 mm 0,57 N/mm (3,27 lbs/in), Firm Yellow (2)	Ressort 14 x 70 mm 0,57 N/mm (3,27 lbs/po), Ferme (jaune) (2)	Molla 14x70 mm 0,57 N/mm (3.27lbs/in) Dura, Gialla (2)
AXIC0224	Spring 14x70mm 1.43lbs/in, Purple (2)	Feder 14 x 70 mm 0,25 N/mm (1,43 lbs/in), Violett (2)	Ressort 14 x 70 mm 0,25 N/mm (1,43 lbs/po), Violet (2)	Molla 14x70 mm 0,25 N/mm (1.43lbs/in), Viola (2)
AXIC1481	AE-5L LED Light Set Only	Nur AE-5L LED-Beleuchtungssatz	Ensemble d'éclairage DEL, AE-5L uniquement	Solo set luci LED AE-5L
AXIC8075	1/10 Falken Wildpeak M T R35 Compound 2.2 Tire with Inserts (2)	1/10 Falken Wildpeak M T R35 Verbindung 2.2 Reifen mit Einsätzen (2)	Pneu Falken Wildpeak MT 1/10 R35 Compound 2.2 avec inserts (2)	Pneumatico compound 2.2 1/10 Falken Wildpeak M T R35 con inserti (2)
AXIC1266	IFD Hex Hub Adapter 2 Front 2 Rear.	IFD Hex Nabenadapter 2 vorn 2 hinten.	Adaptateur moyeu hexagonal IFD, 2 avant et 2 arrière.	Adattatore mozzo esagonale IFD 2 anteriori 2 posteriori.
AXIC231007	23T Metal Servo Horn	23T Metall-Servohorn	Renvoi de commande de servo métallique 23T	Squadretta servo in metallo 23T
AXI43006	2.2 Trail Ready HD Beadlock Satin (2)	2.2 TrailReady HD Beadlock Satin (2)	Verrou de talon HD Trail Ready 2.2, satiné (2)	Cerchioni satinati Beadlock HD 2.2 Trail Ready (2)